



Date: February 13, 2023

From: Wight & Company

Project: D99 Capital Summer 2023

Subject: ADDENDUM #1

Project No: 220242

This addendum forms a part of the Bidding Contract Documents, dated January 23, 2023. Bidders must acknowledge receipt of this Addendum in the space provided on the Bid Form. Revisions are clouded and tagged throughout the drawings with Delta 1.

I. Drawings

CIVIL

1. **SHEET C1.01** (FULL SIZE SHEET REISSUED)
 - Existing storm structure is now to remain.
2. **SHEET C3.00** (FULL SIZE SHEET REISSUED)
 - Notes 11 through 15 have been added.
 - STM 2.0 has been revised
 - Erosion control notes have been added.
 - Storm sewer has been added.
3. **SHEET C4.00** (FULL SIZE SHEET REISSUED)
 - Detail 7 has been revised.
4. **SHEET C4.01** (FULL SIZE SHEET REISSUED)
 - Detail 2 has been revised

II. Photos

Construction Photos twenty-nine (29).

This addendum consists of: (1) Text Pages (4) Drawing Sheets and (29) twenty-nine photos.

END OF ADDENDUM #1

S:\Darien\Downers Grove SD99\220242_North Capital 2023\01\11 Drawings\02 CD\220242 C1.01 DEMOLITION PLAN.dwg devans Feb 10, 2023 9:31:59 am
 Wight © Copyright All rights reserved. No part of these documents may be reproduced, stored, or transmitted in any form or by any means, electronic, mechanical, photocopying, recording or otherwise, without the prior written consent of Wight.

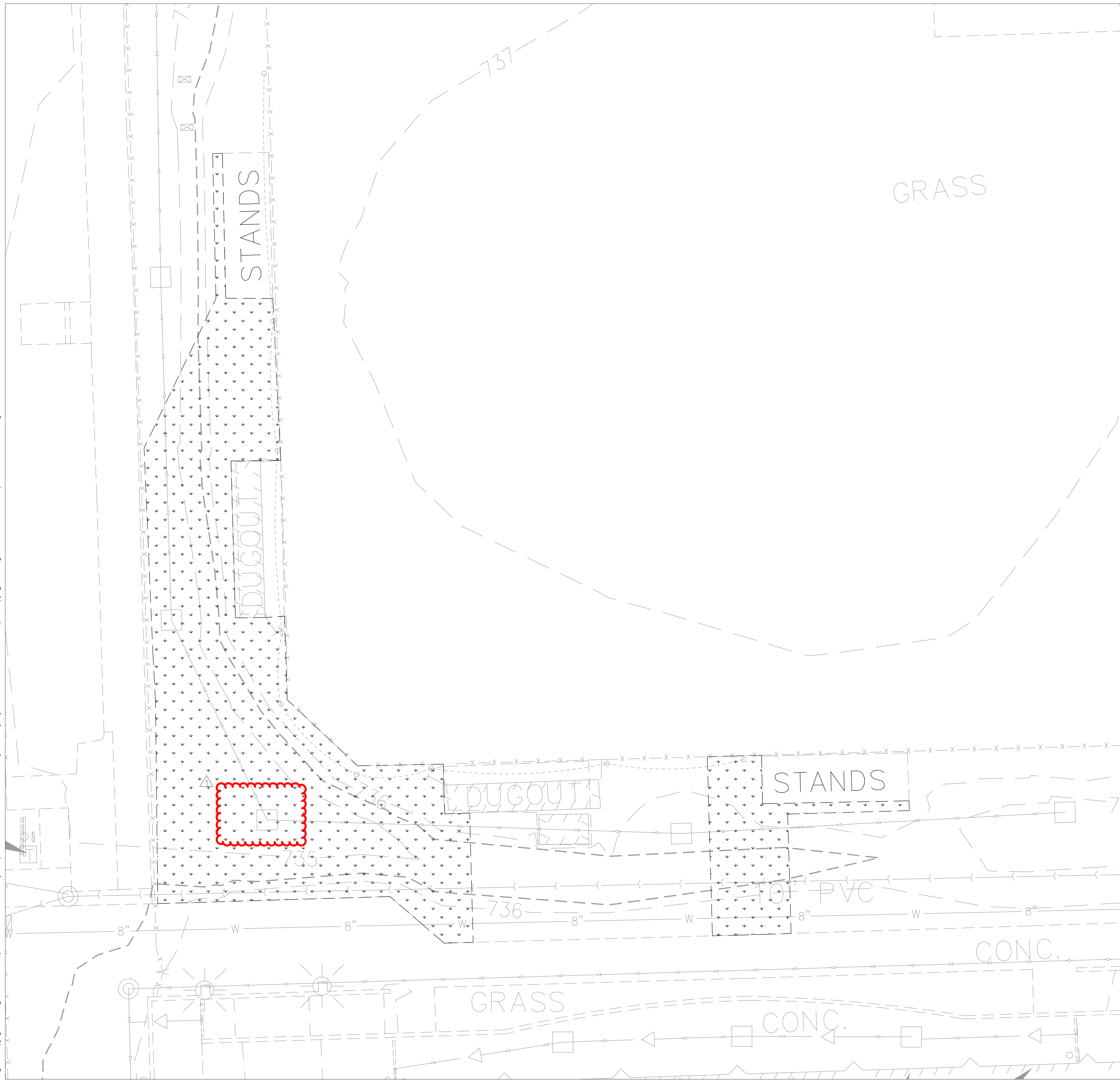

LEGEND

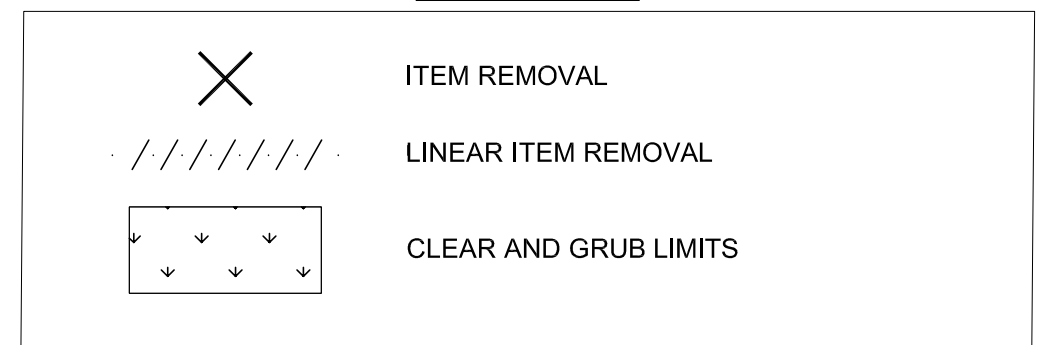

DEMOLITION NOTES

1. CONTRACTOR TO PROTECT ALL EXISTING UTILITIES DURING DEMOLITION & CONSTRUCTION ACTIVITIES. WHETHER SHOWN ON THE PLANS OR NOT, UNLESS OTHERWISE SPECIFIED, ANY RELOCATION, ADJUSTMENTS, CONFLICTS, ETC. SHALL BE BROUGHT TO THE ENGINEER'S ATTENTION IMMEDIATELY. CONTRACTOR TO LOCATE ALL PUBLIC & PRIVATE UTILITIES IN THE RIGHT-OF-WAY AND SITE PRIOR TO CONSTRUCTION.
2. ALL EXISTING CURBS TO REMAIN UNLESS OTHERWISE SPECIFIED. ANY CURB DAMAGED DURING DEMOLITION SHALL BE REPLACED IN KIND.
3. ALL EXISTING SIGNS & LIGHT POLES TO REMAIN AND BE PROTECTED UNLESS OTHERWISE SPECIFIED. ANY SIGNS REMOVED SHALL BE SALVAGED AND RELOCATED OR RETURNED TO OWNER.
4. ANY UTILITY ADJUSTMENTS, CONFLICTS, RELOCATIONS, ETC. REQUIRED SHALL BE COORDINATED WITH ENGINEER AND UTILITY OWNER/PROVIDER.
5. ALL EXISTING TREES TO REMAIN AND TO BE PROTECTED UNLESS OTHERWISE SPECIFIED.
6. ALL DEMOLITION AND CONSTRUCTION IN THE RIGHT-OF-WAY SHALL BE COORDINATED AND APPROVED BY THE VILLAGE OF DOWNERS GROVE. THE CONTRACTOR IS TO CONTACT THE INSPECTORS AT THE VILLAGE OF DOWNERS GROVE PRIOR TO CONSTRUCTION.
7. COORDINATE ALL ELECTRICAL, CABLE FIBER, ETC., REMOVAL/RELOCATION WITH MEP PLANS. CONTRACTOR SHALL PROTECT ALL EXISTING ELECTRIC SERVICES DURING CONSTRUCTION AND NOTIFY ENGINEER IMMEDIATELY OF ANY CONFLICTS.
8. ALL EXISTING SHRUBS AND LANDSCAPING IN CONFLICT WITH SITE IMPROVEMENTS SHALL BE REMOVED.
9. THE CONTRACTOR WILL BE RESPONSIBLE FOR THE REPLACEMENT OF ANY DAMAGED PUBLIC/PRIVATE PROPERTY OR ROADWAY AS A RESULT OF CONSTRUCTION ON THIS SITE. THE RIGHT-OF-WAY MUST BE RESTORED TO EXISTING OR BETTER CONDITION.
10. ITEMS NOTED AS REMOVE AND RELOCATE. SEE LAYOUT PLAN FOR NEW LOCATIONS.



Wight & Company
 wightco.com
 2500 North Frontage Road
 Darien, IL 60561
 P 630.969.7000
 F 630.969.7979

△	ADDENDUM 1	02/10/2023
	IFB	01/23/2023
	CLIENT PAGE TURN	12/14/2022
REV	DESCRIPTION	DATE

**DOWNERS GROVE
 NORTH - SUMMER
 2023 CAPITAL
 IMPROVEMENTS**
 4436 MAIN STREET
 DOWNERS GROVE, IL 60515

DEMOLITION PLAN

Project Number:
 220242
 Drawn By:
 DE
 Sheet:

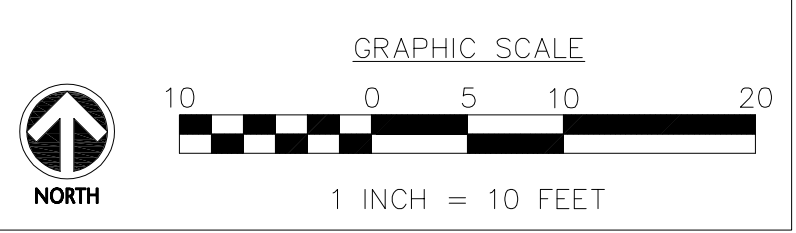

C1.01

S:\Darien\Downers Grove SD99\220242_North Capital 2023\01\11 Drawings\02 CD\220242 C3.00 GRADING AND DRAINAGE PLAN.dwg devans Feb 10, 2023 9:43:45 am
 Wight & Company
 All rights reserved. No part of these documents may be reproduced, stored, or transmitted in any form or by any means, electronic, mechanical, photocopying, recording or otherwise, without the prior written consent of Wight.

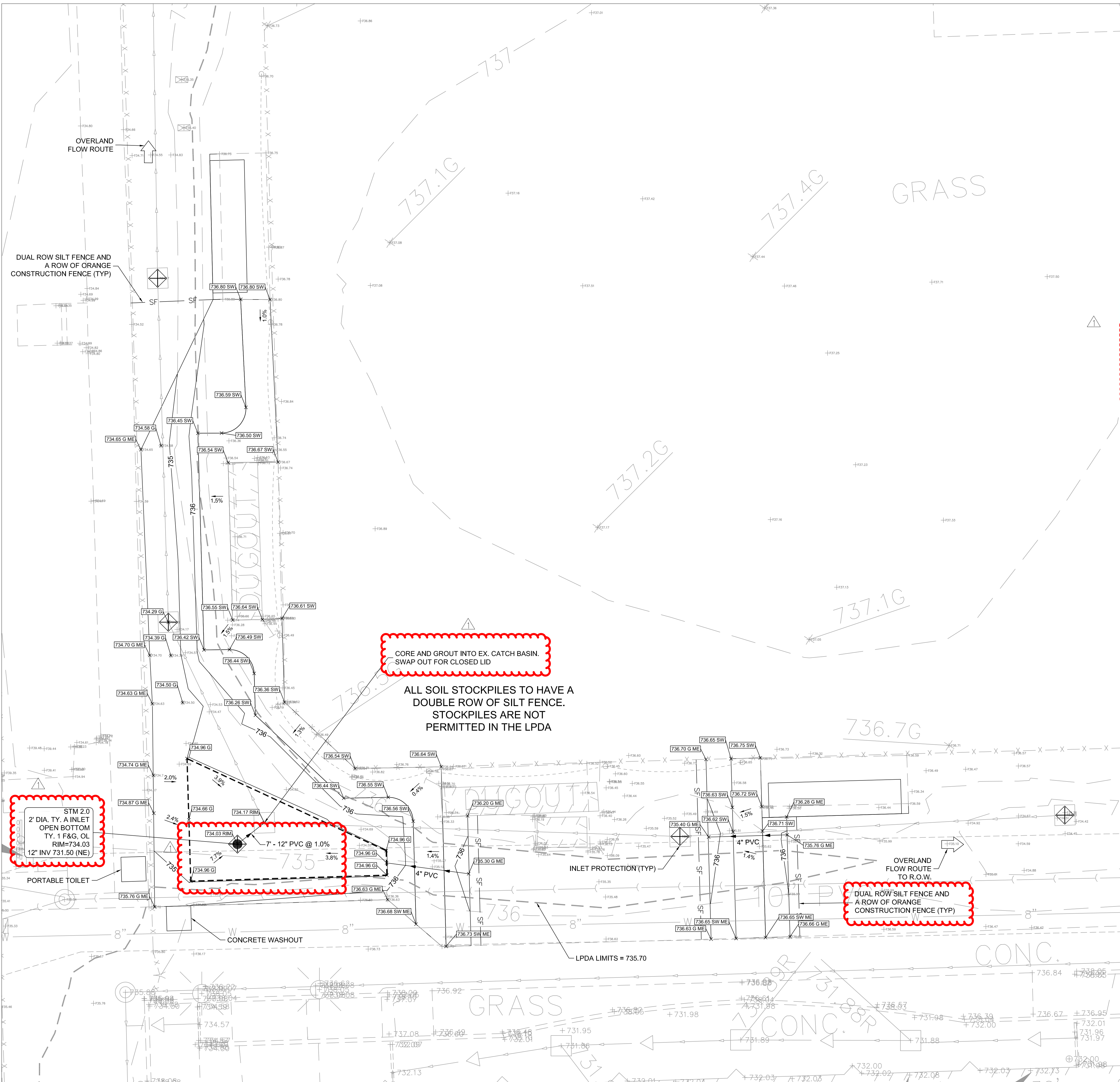

LEGEND

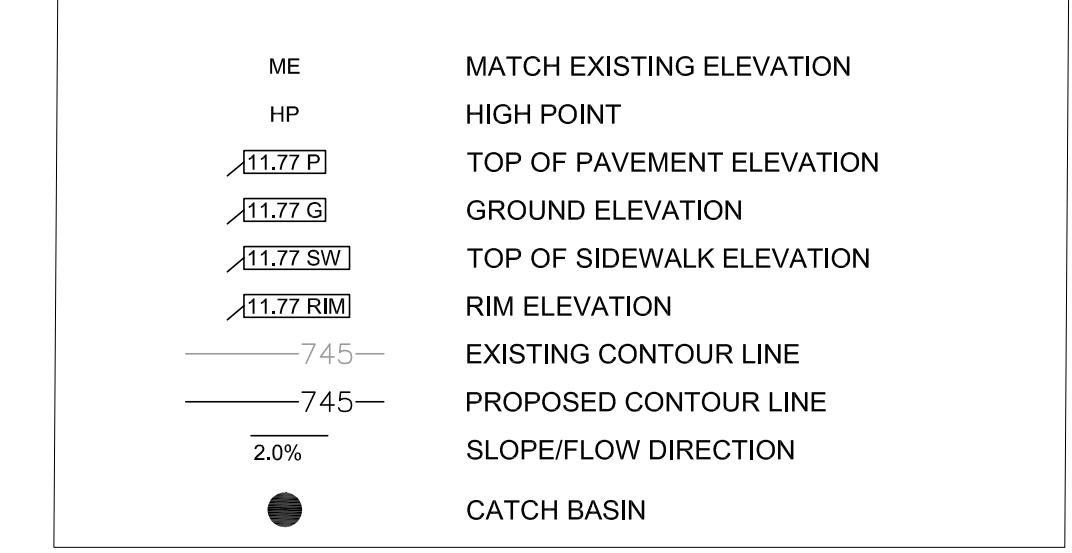

NOTES:

- CONTRACTOR TO VERIFY ALL EXISTING UTILITY LOCATIONS, SIZES, SLOPES, INVERTS, ETC. AND CONTACT ENGINEER IMMEDIATELY IF THERE ARE ANY CONFLICTS/DISCREPANCIES.
- CONTRACTOR TO COORDINATE LOCATIONS, SIZE AND INVERTS WITH MEP PLANS.
- THE CONTRACTOR SHALL PROTECT ANY AND ALL TREES EITHER SHOWN OR NOT SHOWN ON THE PLANS UNLESS OTHERWISE SPECIFIED. MINIMUM PROTECTION FOR TREES SHALL BE 4' SNOW FENCE INSTALLED ALONG THE DRIP LINE OF TREES.
- CONTRACTOR TO PROTECT ALL EXISTING UTILITIES.
- ALL EXISTING UTILITY STRUCTURES SHALL BE ADJUSTED AS NECESSARY TO MATCH FINISH GRADE. ALL EXISTING UTILITY STRUCTURES REQUIRING ADJUSTMENT OR RECONSTRUCTION SHALL BE COMPLETED BY THE CONTRACTOR TO THE SATISFACTION OF THE UTILITY OWNER. ADJUSTMENTS AND/OR RECONSTRUCTIONS NOT CALLED FOR ON THE PLANS SHALL BE CONSIDERED INCIDENTAL TO THE CONTRACT. NO MORE THAN A TOTAL OF 12 INCHES OF ADJUSTING RINGS AND/OR 2 ADJUSTING RINGS SHALL BE ALLOWED.
- ALL SITE WORK SHALL BE IN CONFORMANCE WITH THE ILLINOIS ACCESSIBILITY CODE AND WITH THE AMERICANS WITH DISABILITIES ACT.
- RAMPS SHALL NOT EXCEED A RUNNING SLOPE OF 1:12 (8.33%).
- MAXIMUM CROSS-SLOPE ON ANY WALK OR RAMPS SHALL BE 2%. ALL ACCESSIBLE PARKING SPACES AND LOADING ZONES SHALL HAVE A MAXIMUM SLOPE OF 2% IN ANY DIRECTION.
- SEE SWPPP PLAN FOR ALL EROSION AND SEDIMENT CONTROL NOTES, STANDARDS, INSPECTIONS, MAINTENANCE AND PRACTICES THAT NEED TO BE FOLLOWED.
- DRAINAGE SWALS SHALL BE CONSTRUCTED OF ESTABLISHED VEGETATION (SOD OR NATIVE).
- INSTALL CONSTRUCTION FENCE AROUND THE AREA OF THE SWAMP PRIOR TO ANY OTHER ON-SITE CONSTRUCTION OR DEMOLITION (SHOW THE FENCE ON THE SITE PLAN).
- CALL COMMUNITY DEVELOPMENT AT 630-434-5529 FOR AN INSPECTION OF THE DRYWELL INFILTRATION TRENCH PRIOR TO BACKFILLING TO VERIFY THE DIMENSIONS, FABRIC PLACEMENT, AND BACKFILL MATERIAL.
- LOCATE THE DRYWELL IN A SLIGHTLY DEPRESSED AREA TO PROMOTE INFILTRATION.
- IF GROUNDWATER IS ENCOUNTERED DURING CONSTRUCTION, THE BOTTOM ELEVATION OF THE DRYWELL SHALL BE RAISED ABOVE THE SEASONALLY HIGH WATER TABLE. THE LENGTH AND WIDTH OF THE DRYWELL SHALL BE ADJUSTED ACCORDINGLY TO MAINTAIN REQUIRED VOLUME.
- INFILTRATION OVER SOILS WITH THE SEASONALLY HIGH GROUNDWATER TABLE WITHIN TWO (2) FEET OF THE SURFACE WILL NOT BE PERMITTED.

GEOTECH NOTE:

FOLLOW ALL RECOMMENDATIONS, REQUIREMENTS, REMEDIATION, ETC. AS SPECIFIED IN THE "SUBSURFACE EXPLORATION AND GEOTECHNICAL ENGINEERING REPORT" PROVIDED BY ECS MIDWEST LLC. ANY DISCREPANCIES BETWEEN THE REPORTS, NOTES AND SPECIFICATIONS, THE MORE STRINGENT SHALL APPLY.

EARTHWORK NOTES:

CONTRACTOR IS RESPONSIBLE FOR DETERMINING EXACT EARTHWORK REQUIREMENTS (CUT, FILL, HAUL IN/OFF, ETC.) TO BRING SITE TO FINISHED GRADE. ANY ON-SITE RE-USE OF ON-SITE DEMOLITION DEBRIS/MATERIALS MUST BE APPROVED BY THE GEOTECHNICAL ENGINEER.

AS-BUILT NOTES:

THE CONTRACTOR IS RESPONSIBLE FOR ALL AS-BUILT SURVEYS. ALL AS-BUILT SURVEYS SHALL BE COMPLETED BY A PROFESSIONAL LAND SURVEYOR AND BE SIGNED AND SEALED. THE CONTRACTOR SHALL SUBMIT TWO SETS OF THE "AS-BUILT" FINAL ENGINEERING DRAWINGS (I.E. RECORD DRAWINGS) AND STORMWATER MANAGEMENT CALCULATIONS UPON COMPLETION OF IMPROVEMENTS AND INCLUDE ELECTRONIC CAD FILES. THE RECORD DRAWINGS SHOULD AT LEAST INCLUDE THE FOLLOWING INFORMATION: AS-BUILT DETENTION CONTOURS, ELEVATIONS (INCLUDING DETENTION BASIN TOP OF BERM AND OVERFLOW WEIR GRADES) AND VOLUME (VERIFIED, SIGNED, & SEALED BY A PROFESSIONAL ENGINEER (PE) OR PROFESSIONAL LAND SURVEYOR (PLS)); ELEVATION AND LOCATION TIES TO TWO POINTS OF ALL NEW STRUCTURES INCLUDING FIRE HYDRANTS, VALVE BOXES AND VAULTS, LINES/STOP SLEEVES, WATER SERVICE CORPORATION STOPS, WATER MAIN FITTINGS/BENDS, MANHOLES, SANITARY SERVICE WYES (MEASURED FROM DOWNSTREAM MANHOLE), ALL STORM/SANITARY SEWER STRUCTURES (INCLUDING INVERTS AND PIPE SIZES), ALL PIPES (LOCATIONS, SLOPES, LENGTHS, ETC.), OUTLET CONTROL STRUCTURES (INCLUDING RESTRICTOR SIZES AND ELEVATIONS PLUS TOP OF WALL) AND ABANDONED WATER OR SANITARY SERVICE LINES. DETAILED TOPOGRAPHIC SURVEY OF ALL HIGH POINTS, LOW POINTS, CHANGE OF SLOPE INCLUDING GUTTER GRADES, TOP OF CURB GRADES, PAVEMENT GRADES, SIDEWALK GRADES, RAMP GRADES, ETC. TO VERIFY POSITIVE DRAINAGE. ALL ELEVATIONS SHOULD BE REFERENCED TO THE SAME BENCHMARK DATUM AS THE ORIGINAL DESIGN PLANS. HORIZONTAL TIES SHALL BE REFERENCED TO LOT LINES, BACK OF CURB, OR PROPERTY CORNERS. WITHIN DETENTION/BMP AREAS: FOR VERIFICATION OF DETENTION VOLUME AND SUBBASE GRADES, PRIOR TO BACK FILLING WITH CA-7, THE CONTRACTOR SHALL PROVIDE ENGINEER WITH A CERTIFIED TOPO SURVEY OF AS-BUILT SUBBASE GRADES FOR ENGINEER APPROVAL AND ALSO A COPY OF RECEIPT OF THE CA-7 AGGREGATE.

VILLAGE OF DOWNERS GROVE NOTES

- ONE FULL SIZE HARD COPY OF THE AS-BUILT FINAL GRADING SURVEY (PRINTED TO SCALE) MUST BE SUBMITTED PRIOR TO SCHEDULING THE FINAL STORMWATER/RIGHT-OF-WAY INSPECTION FOR THE PROJECT. AS APPLICABLE, IT SHALL ALSO INCLUDE THE AS-BUILT STORAGE VOLUME OF ANY RESIDENTIAL STORMWATER STORAGE (RSS) OR POST CONSTRUCTION BEST MANAGEMENT PRACTICES (PCBMPs). BEFORE THE PERMIT CAN BE CLOSED, AN ELECTRONIC COPY OF THE APPROVED GRADING SURVEY IS REQUIRED.
- A FINAL GRADING SURVEY IS REQUIRED AT THE COMPLETION OF THE PROJECT, INCLUDING AN ELECTRONIC COPY (TIFF FORMAT). IT SHALL INCLUDE, BUT IS NOT LIMITED TO, THE FOLLOWING ITEMS:
 - SUMP PUMP DISCHARGE LOCATION, SIZE, AND MATERIAL OF ANY ASSOCIATED PIPING (SUMP PUMP DISCHARGE SHALL BE AT LEAST 20 FEET FROM THE DOWNSTREAM PROPERTY LINE)
 - DOWNSPOUT LOCATION, DISCHARGE PATH, AND THE LOCATION, SIZE, AND MATERIAL OF ANY ASSOCIATED PIPING (DOWNSPOUT DISCHARGE SHALL BE AT LEAST 20 FEET FROM THE DOWNSTREAM PROPERTY LINE)
 - TOP OF FOUNDATION ELEVATIONS OF ALL NEW STRUCTURES
 - SPOT GRADES ADJACENT TO THE FOUNDATIONS OF ALL NEW STRUCTURES
 - ALL NEW IMPERVIOUS AREAS INCLUDING THOSE MADE OF CONCRETE, ASPHALT, AND BRICK
 - STOOPS OUTSIDE OF DOORWAYS
 - WINDOW WELL LOCATIONS, ELEVATIONS, AND THE ADJACENT GRADE
 - AS-BUILT SWALE CROSS SECTIONS AND SWALE CAPACITY CALCULATIONS.
 - UPDATED CALCULATIONS OF THE AS-BUILT IMPERVIOUS AREAS. TABULATE TO SHOW THE NET INCREASE IN IMPERVIOUS AREA (ANY INCREASE IN IMPERVIOUS AREA FROM THE PROPOSED WILL RESULT IN AN ADDITIONAL FEE).
- EROSION CONTROL NOTES:
 - AN INITIAL SEDIMENTATION AND EROSION CONTROL INSPECTION IS REQUIRED PRIOR TO STARTING CONSTRUCTION. THE APPLICANT IS DIRECTED TO CONTACT THE COMMUNITY DEVELOPMENT DEPARTMENT AT 630-434-5529 TO SCHEDULE THIS INSPECTION; THIS NOTIFICATION SHALL BE AT LEAST 24 HOURS IN ADVANCE OF CONSTRUCTION.
 - THE SEDIMENT AND EROSION CONTROL DEVICES SHALL BE FUNCTIONAL BEFORE ANY LAND IS DISTURBED ON THE SITE.
 - STOCKPILES OF SOIL SHALL NOT BE LOCATED WITHIN ANY DRAINAGEWAYS, FLOODPLAINS, WETLANDS, BUFFERS OR LPDAS.
 - SEDIMENT AND EROSION CONTROL SHALL BE PROVIDED FOR ANY SOIL STOCKPILE IF IT IS TO REMAIN FOR MORE THAN THREE DAYS INCLUDING A DOUBLE ROW OF SILT FENCE OR COIR ROLL. PROPERTIES DOWNSTREAM FROM THE SITE SHALL BE PROTECTED FROM EROSION IF THE VOLUME, VELOCITY, SEDIMENT LOAD, OR PEAK FLOW RATES OF STORMWATER RUNOFF ARE TEMPORARILY INCREASED DURING CONSTRUCTION.
 - STORM SEWER INLETS SHALL BE PROTECTED WITH SEDIMENT TRAPPING OR FILTER CONTROL DEVICES DURING CONSTRUCTION.
 - THE SURFACE OF STRIPPED AREAS SHALL BE PERMANENTLY OR TEMPORARILY PROTECTED FROM SOIL EROSION WITHIN SEVEN DAYS AFTER FINAL GRADE IS REACHED. STRIPPED AREAS THAT WILL REMAIN UNDISTURBED FOR MORE THAN SEVEN DAYS AFTER INITIAL DISTURBANCE SHALL BE PROTECTED FROM EROSION.
 - WATER PUMPED OR OTHERWISE DISCHARGED FROM THE SITE DURING CONSTRUCTION DEWATERING SHALL BE FILTERED.
 - A STABILIZED CONSTRUCTION ENTRANCE SHALL BE PROVIDED TO PREVENT THE DEPOSITION OF SOIL ONTO PUBLIC OR PRIVATE ROADWAYS. ANY SOIL REACHING A PUBLIC OR PRIVATE ROADWAY SHALL BE REMOVED BEFORE THE END OF EACH WORKDAY.
 - ALL TEMPORARY EROSION CONTROL MEASURES NECESSARY TO MEET THE REQUIREMENTS OF THE VILLAGE OF DOWNERS GROVE STORMWATER AND FLOOD PLAN ORDINANCE SHALL BE KEPT OPERATIONAL AND MAINTAINED CONTINUOUSLY THROUGHOUT THE PERIOD OF LAND DISTURBANCE UNTIL PERMANENT SEDIMENT AND EROSION CONTROL MEASURES ARE OPERATIONAL.
 - ALL TEMPORARY EROSION AND SEDIMENT CONTROL MEASURES SHALL BE REMOVED WITHIN THIRTY (30) DAYS AFTER FINAL STABILIZATION IS ACHIEVED. TRAPPED SEDIMENT AND OTHER DISTURBED SOILS RESULTING FROM TEMPORARY MEASURES SHALL BE PROPERLY DISPOSED OF PRIOR TO PERMANENT STABILIZATION.

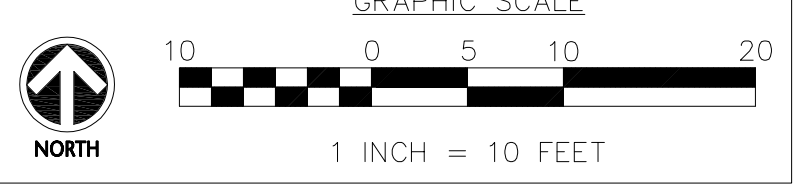

CORE AND GROUT INTO EX. CATCH BASIN. SWAP OUT FOR CLOSED LID

ALL SOIL STOCKPILES TO HAVE A DOUBLE ROW OF SILT FENCE. STOCKPILES ARE NOT PERMITTED IN THE LPDA

STM 2.0
2' DIA. TY. A INLET
OPEN BOTTOM
TY. 1 F&G, OL
RIM=734.03
12" INV 731.50 (NE)

DUAL ROW SILT FENCE AND A ROW OF ORANGE CONSTRUCTION FENCE (TYP)



Wight & Company
wightco.com
2500 North Frontage Road
Darien, IL 60561
P 630.969.7000
F 630.969.7979

REV	DESCRIPTION	DATE
ADDENDUM 1		02/10/2023
IFB		01/23/2023
CLIENT PAGE TURN		12/14/2022

DOWNERS GROVE NORTH - SUMMER 2023 CAPITAL IMPROVEMENTS
 4436 MAIN STREET
 DOWNERS GROVE, IL 60515

GRADING AND DRAINAGE PLAN

Project Number: 220242
 Drawn By: DE
 Sheet:

C3.00

S:\Darien\Downers Grove SD99\220242_North Capital 2023\01\11 Drawings\02 CD\220242 C4.00 CIVIL DETAILS.dwg devans Feb 10, 2023 9:51:35 am
 Wight © Copyright All rights reserved. No part of these documents may be reproduced, stored, or transmitted in any form or by any means, electronic, mechanical, photocopying, recording or otherwise, without the prior written consent of Wight.

SILT FENCE PLAN

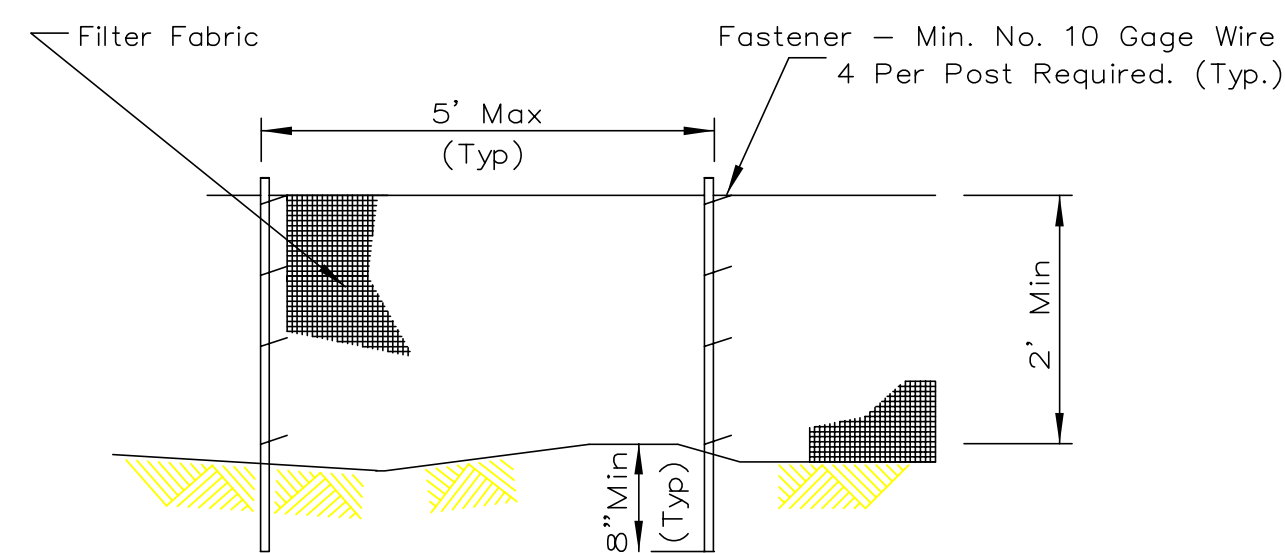

ELEVATION

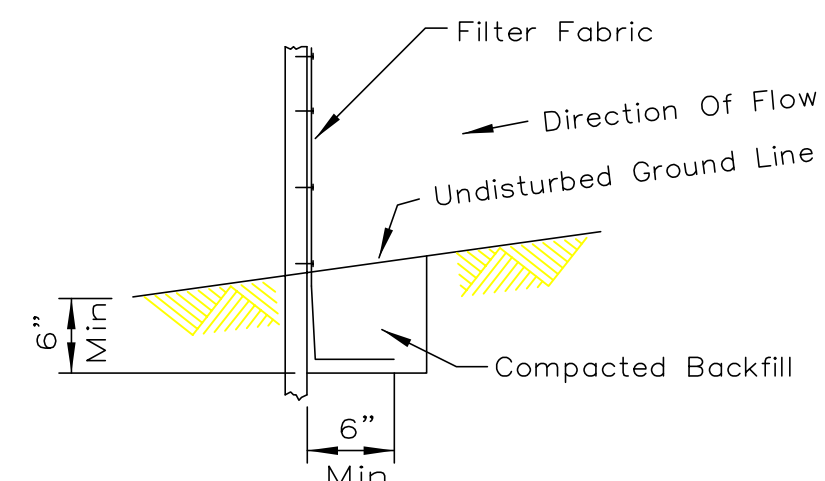

FABRIC ANCHOR DETAIL

- NOTES:
1. Temporary sediment fence shall be installed prior to any grading work in the area to be protected. They shall be maintained throughout the construction period and removed in conjunction with the final grading and site stabilization.
 2. Filter fabric shall meet the requirements of material specification 592 Geotextile Table 1 or 2, Class with equivalent opening size of at least 30 for nonwoven and 40 for woven.
 3. Fence posts shall be either standard steel post or wood post with a minimum cross-sectional area of 3.0 sq. in.

REFERENCE	STANDARD DWG. NO.
Project _____	IUM-620
Designed _____ Date _____	SHEET 1 OF 2
Checked _____ Date _____	DATE 3-16-12
Approved _____	

2 DROP INLET PROTECTION

INLET FILTER

TYPE 1 BOUND INLET FILTER DEPICTED

NOTE: ROUND AND SQUARE/RECTANGULAR INLET FILTERS AVAILABLE FOR MOST NEENAH AND EAST JORDAN BEEHIVE, ROLL CURB AND CURB BOX FRAME TYPES.

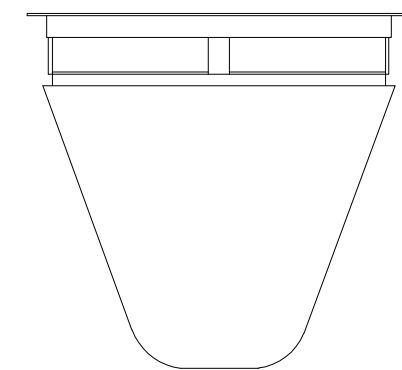

IDOT STANDARD FRAME SELECTION

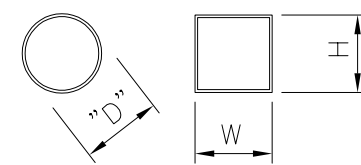

**CERTIFICATION: ALL IPP INLET FILTERS CONFORM TO IDOT SPECIFICATIONS AS OUTLINED IN ARTICLE 1081.15 OF IDOT'S STANDARDS SPECIFICATIONS GUIDE

IDOT Std	Grate Size	Opening	Filter P/N	Approx Dims	Notes
Type 1.5	22.75 dia	21	2200-1	D=22	Round
Type 8	33 dia	23 (hole)	2600-8	D=26.5	Round
Type 3, 3V	22 x 16.9	20 x 15	2116-3CB	W=21, H=16	Curb box, flap
Type 11, 11V	28.75 x 11.38	27 x 9.875	2811-11CB	W=28, H=11	Curb box, flap
Type 6	22 x 22.75	20.25 x 23+	2122-6	W=21, H=22	Roll curb
Type 12	28.75 x 17.25	27 x 16.5+	2817-12	W=28, H=16	Roll curb
Type 4	21.75 x 14.75	20 x 13	2114-4	W=21, H=14	Rect flat
Type 20, 21, 22	22.5 x 22.5	20 x 20	2222-20	W=22, H=22	Square flat
Type 23	24 x 16.25	22 x 14.5	2316-23	W=23, H=15	Rect flat
Type 24	24 x 22.5	22 x 20.5	2322-24	W=23, H=22	Rect flat

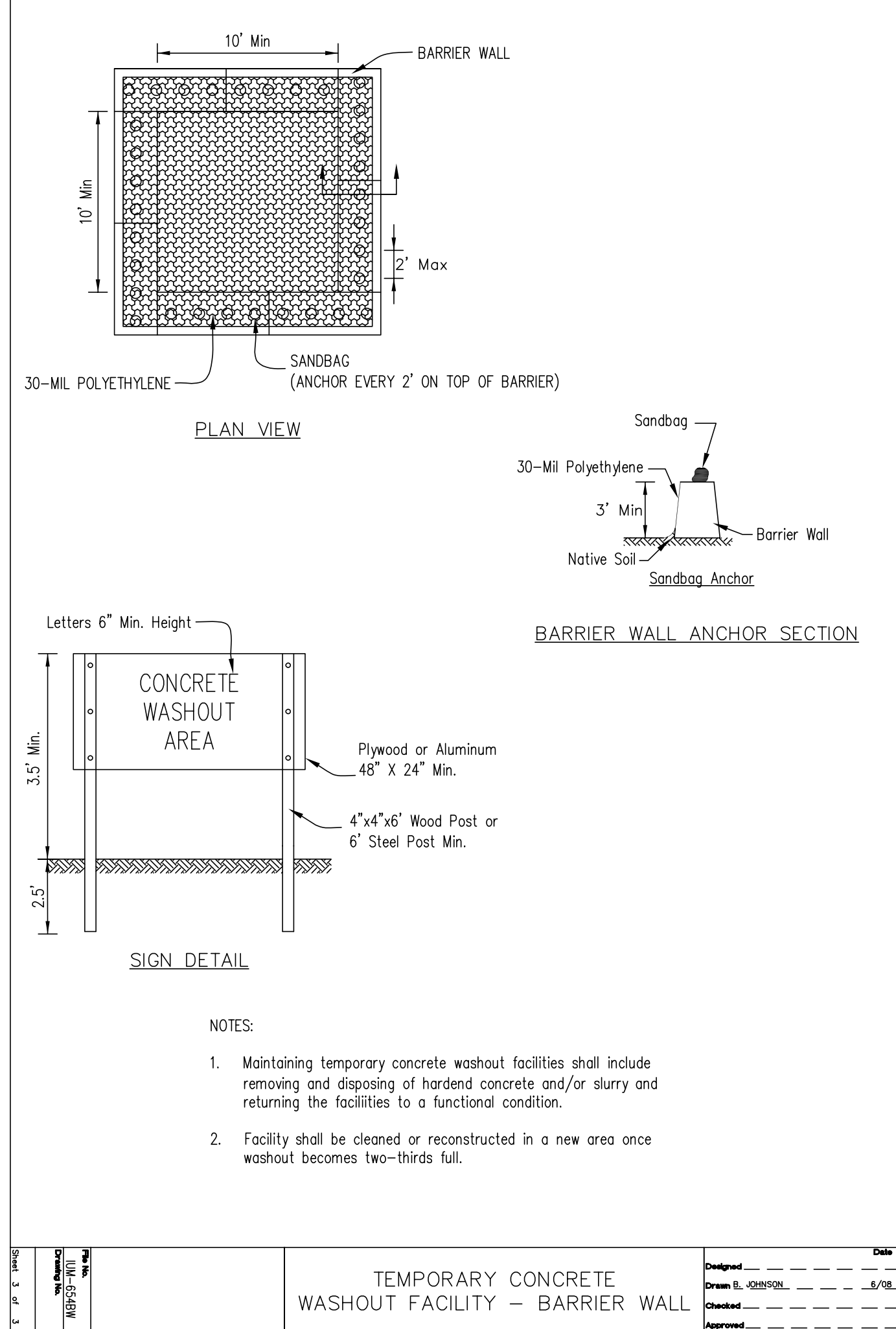

- NOTES:
1. Maintaining temporary concrete washout facilities shall include removing and disposing of hardened concrete and/or slurry and returning the facilities to a functional condition.
 2. Facility shall be cleaned or reconstructed in a new area once washout becomes two-thirds full.

TEMPORARY CONCRETE WASHOUT FACILITY - BARRIER WALL

4 PCC SIDEWALK

WELDED WIRE IS NOT PERMITTED IN THE CITY RIGHT-OF-WAY

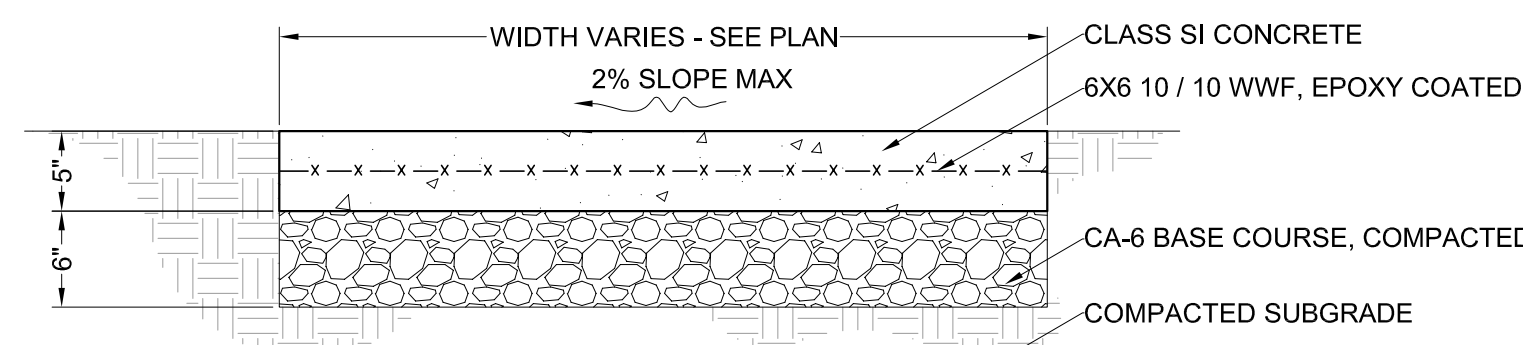

- NOTES:
1. ALL SIDEWALKS SHALL BE CONSTRUCTED WITH IDOT CLASS SI CONCRETE, NOT LESS THAN 3500 P.S.I. CONCRETE AT 14 DAYS.
 2. SIDEWALK THICKNESS CROSS DRIVEWAY SHALL BE A MINIMUM 8\"/>

5 MITER DRAIN

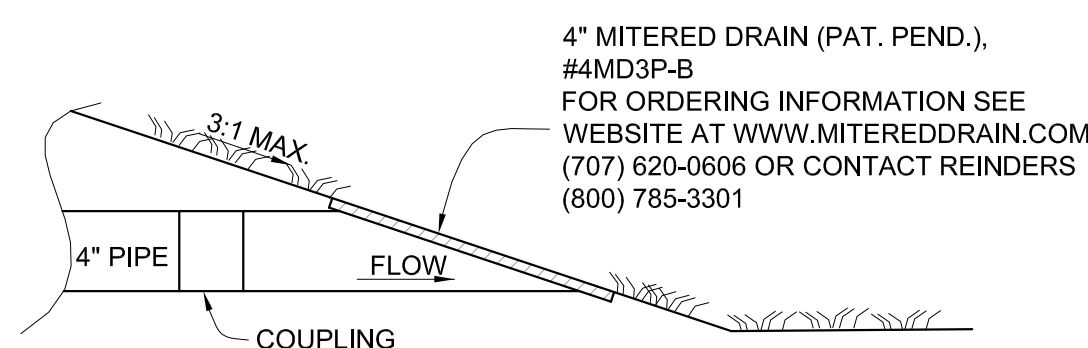

4\"/>

6 JOINT DETAILS

EXPANSION JOINT

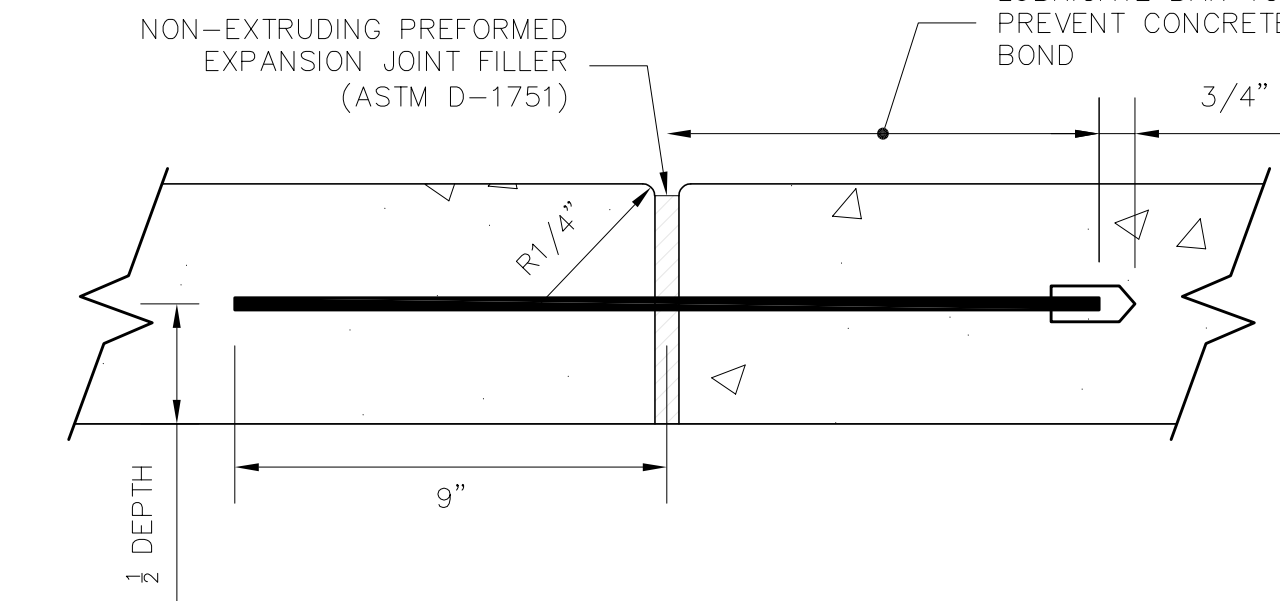

- NOTES:
1. PREFORMED FLEXIBLE FOAM EXPANSION JOINT FILLER NOT ACCEPTED.
 2. EACH EXPANSION JOINT SHALL HAVE (2) 3/8\"/>

CONTROL JOINT

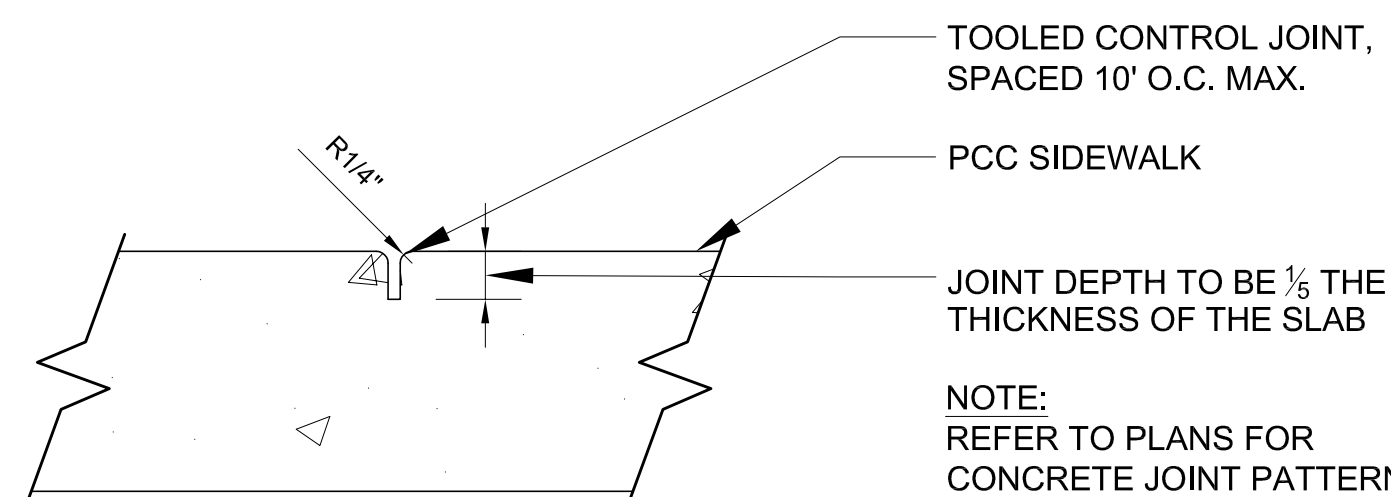

NOTE: REFER TO PLANS FOR CONCRETE JOINT PATTERN

7 BMP #1 BIO-INFILTRATION

BIO-INFILTRATION #1 SUMMARY

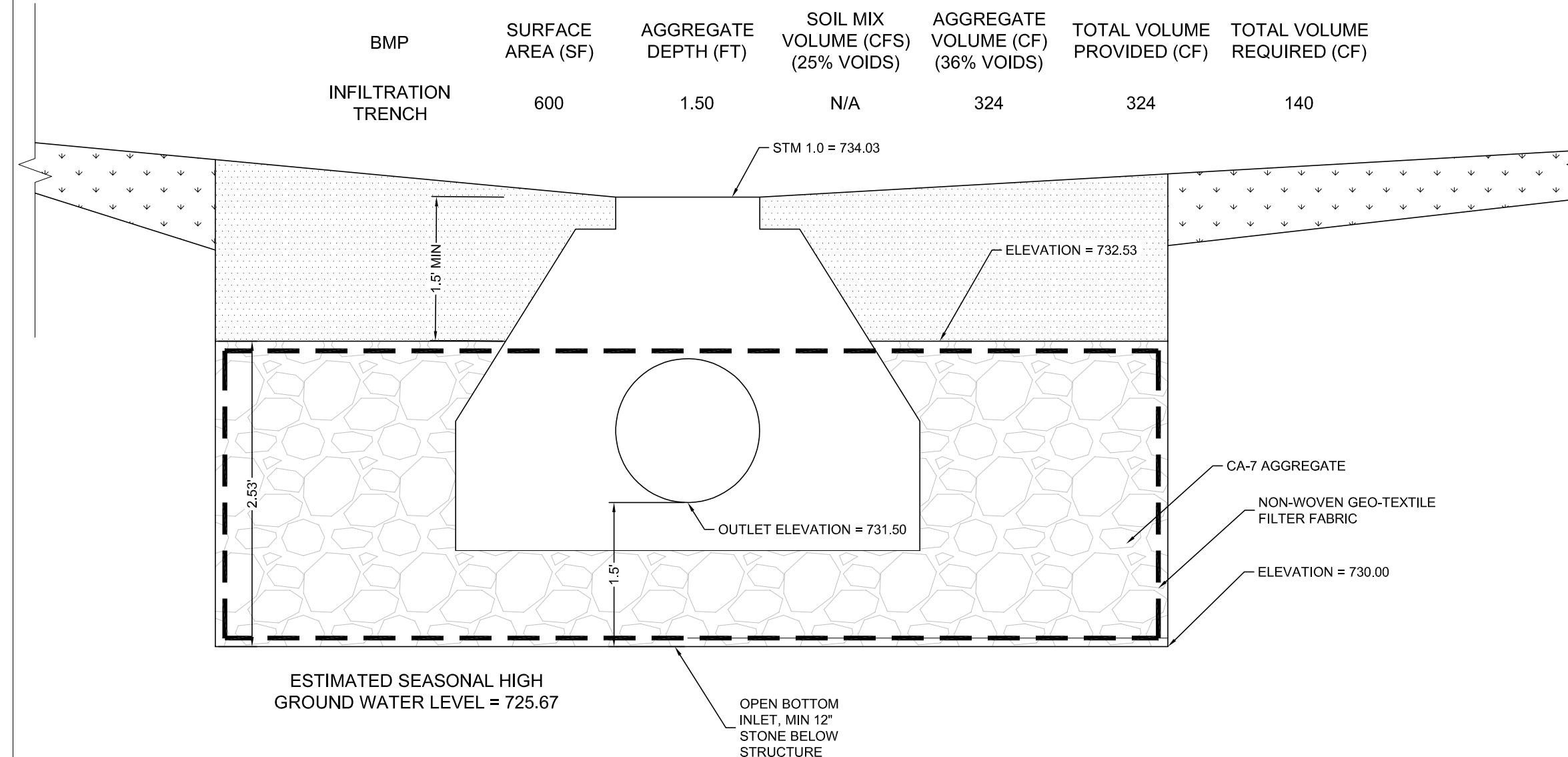

AS-BUILT NOTE FOR RAIN GARDEN & INFILTRATION TRENCH:
 WITHIN BMP AREAS: FOR VERIFICATION OF BMP VOLUME AND SUBBASE GRADES, PRIOR TO BACK FILLING WITH CA-7. THE CONTRACTOR SHALL PROVIDE ENGINEER WITH A CERTIFIED TOPO SURVEY OF AS-BUILT SUBBASE GRADES FOR ENGINEER APPROVAL AND ALSO A COPY OF RECEIPT OF THE CA-7 AGGREGATE.

SEQUENCING NOTE FOR BIO-INFILTRATION TRENCH:
 BMP AREAS TO BE CONSTRUCTED TOWARDS THE END OF CONSTRUCTION, PRIOR TO INSTALLATION OF LANDSCAPE AND FINAL SITE STABILIZATION. CONSTRUCTION EQUIPMENT IS NOT ALLOWED IN THE AREAS OF THE BMP SUBGRADE

BIO-INFILTRATION AREAS

PROPERLY DESIGNED AND INSTALLED BIOINFILTRATION SYSTEMS REQUIRE LITTLE MAINTENANCE. DURING PERIODS OF EXTENDED DROUGHT, BIOINFILTRATION SYSTEMS MAY REQUIRE WATER APPROXIMATELY EVERY 10 DAYS.

- AS NEEDED:
- WATER DURING FIRST GROWING SEASON
 - WATER DURING DRY PERIODS AFTER FIRST GROWING SEASON
 - TREAT DISEASED SOD AREA
 - KEEP OVERFLOW FREE AND CLEAR OF LEAVES

- MONTHLY:
- INSPECT SOIL AND REPAIR ERODED AREAS
 - REMOVE LITTER AND DEBRIS
 - CLEAR LEAVES AND DEBRIS FROM OVERFLOW

- TWICE PER YEAR:
- INSPECT SOD TO EVALUATE HEALTH

- ONCE PER YEAR:
- INSPECT FACILITY AND PRETREATMENT AREAS FOR SEDIMENT BUILDUP, EROSION, VEGETATIVE CONDITIONS, ETC.



Wight

Wight & Company
 wightco.com
 2500 North Frontage Road
 Darien, IL 60561
 P 630.969.7000
 F 630.969.7979

ADDENDUM 1	02/10/2023	
IFB	01/23/2023	
CLIENT PAGE TURN	12/14/2022	
REV	DESCRIPTION	DATE

DOWNERS GROVE NORTH - SUMMER 2023 CAPITAL IMPROVEMENTS

4436 MAIN STREET
 DOWNERS GROVE, IL 60515

CIVIL DETAILS

Project Number:
 220242
 Drawn By:
 DE
 Sheet:

C4.00

1 PIPE BEDDING & BACKFILL - STORM SEWER
SCALE: NTS

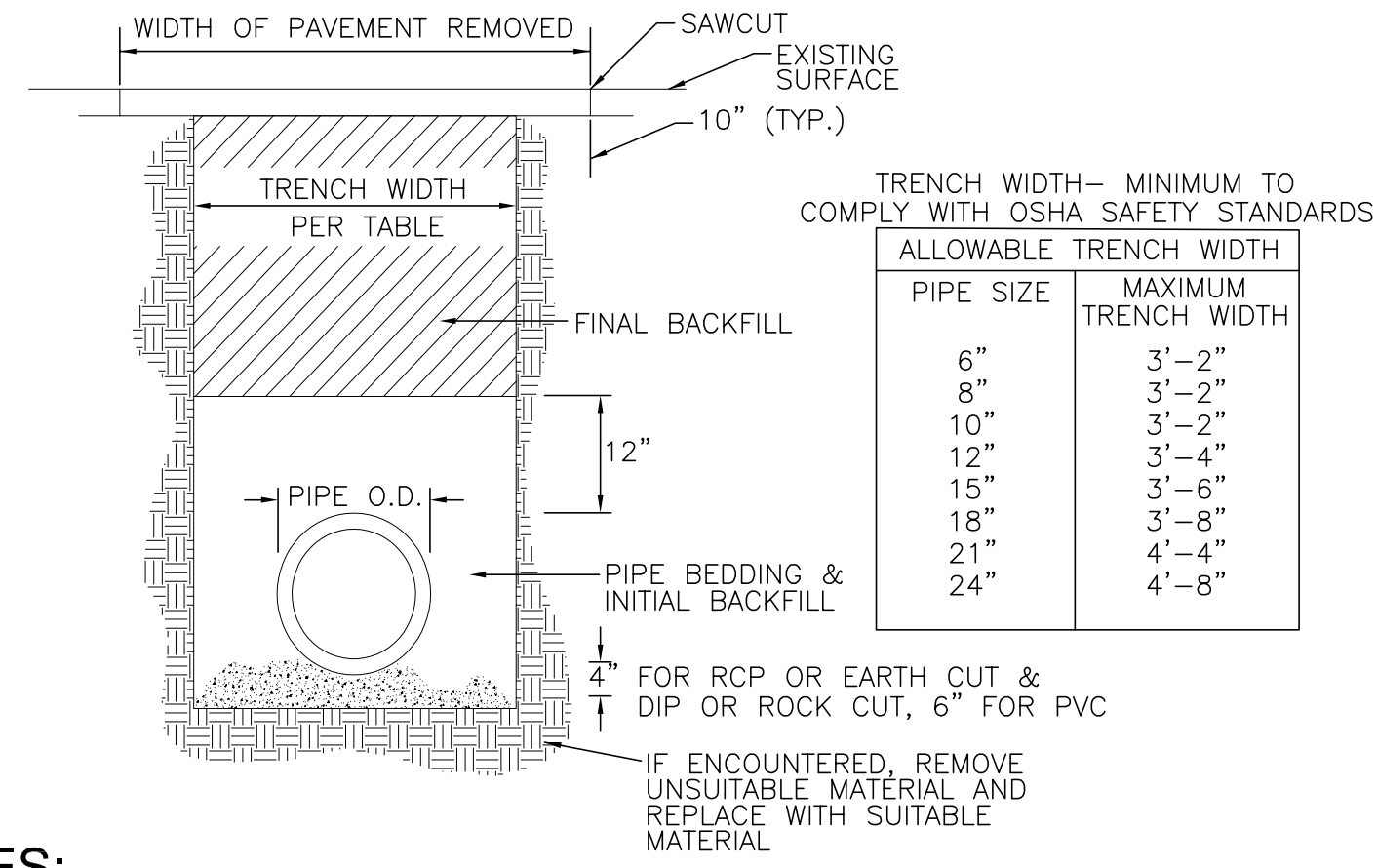

NOTES:

- TRENCH WIDTH - MINIMUM TO COMPLY WITH OSHA SAFETY STANDARDS.
- REINFORCING OF RESTORED PAVEMENT MUST MATCH EXISTING.
- RESTORATION TO ORIGINAL SURFACE REQUIRED. NO CONCRETE PATCHES ON ASPHALT ROADS.
- STREETS MUST REMAIN OPEN TO TRAFFIC WORK ON ONLY ONE HALF OF STREET ALLOWED AT A TIME. CONTRACTORS SHALL ERECT AND MAINTAIN SUFFICIENT AND SUITABLE SIGNS AND BARRICADES DURING AND AFTER CONSTRUCTION.
- STREETS SHALL BE RESTORED TO THEIR ORIGINAL CONDITION WITHIN 72 HOURS FROM THE TIME THE WORK COMMENCED. STREET OPENINGS SHALL BE BACKFILLED WITH APPROVED GRANULAR MATERIAL AND A TEMPORARY PAVEMENT SURFACE OF COMPACTED COLD ASPHALT MATERIAL SHALL BE INSTALLED WITHIN 24 HOURS FROM THE TIME THE WORK COMMENCED.
- A MINIMUM OF 24 HOURS NOTICE MUST BE GIVEN TO THE MUNICIPALITY BEFORE BACKFILLING AND RESTORATION WORK ARE TO COMMENCE.

PIPE BEDDING & INITIAL BACKFILL
FOR PVC AND HDPE, CRUSHED STONE (IDOT CA-11 OR CA-13) TO 1 FOOT OVER PIPE. FOR RCP & DIP, CA-6 TO SPRING LINE. PLACE IN MAXIMUM 6" LIFTS AND COMPACTED TO 95% STANDARD PROCTOR DENSITY PER AASHTO T-99.

FINAL BACKFILL
IN PAVEMENT AREAS AND WHERE TRENCH FALLS WITHIN A 1 TO 1 SLOPE EXTENDED FROM THE EDGE OF THE PAVEMENT, MATERIAL SHALL BE TRENCH-BACKFILL (CA-6 PER I.D.O.T. SPECS.) COMPACTED TO 95% STANDARD PROCTOR DENSITY PER AASHTO T-99.

IN AREAS WHERE GRASS IS REMOVED AND PARKWAY RESTORATION IS REQUIRED LANDSCAPE FABRIC SHALL BE PLACED BETWEEN THE BACKFILLED MATERIAL AND THE REQUIRED TOPSOIL AS DIRECTED BY THE MUNICIPAL DIRECTOR OF PUBLIC WORKS.

IN LANDSCAPE AREAS MATERIAL SHALL BE SELECT, EXCAVATED MATERIAL, FREE OF ROCKS AND DEBRIS COMPACTED TO 85% STANDARD PROCTOR DENSITY PER AASHTO T-99.

UTILITY CROSSINGS
AT UTILITY CROSSINGS, INSTALL TRENCH BACKFILL, AS ABOVE, FROM THE PIPE BEDDING TO 1 FOOT OVER THE HIGHER PIPE. SUCH A GRANULAR CRADLE SHALL BE CONSTRUCTED REGARDLESS OF WHETHER THE CROSSING OCCURS IN PAVED OR LANDSCAPED AREAS.

WHERE UTILITY CROSSINGS INCLUDE A WATER MAIN, USE CLASS IV COMPACTED SELECT EXCAVATED MATERIAL BETWEEN PIPES AS REQUIRED BY THE STANDARD SPECIFICATIONS FOR SEWER & WATER MAIN CONSTRUCTION IN ILLINOIS, STANDARD DRAWINGS 19 THROUGH 24.

2 INLET, TYPE A
SCALE: NTS

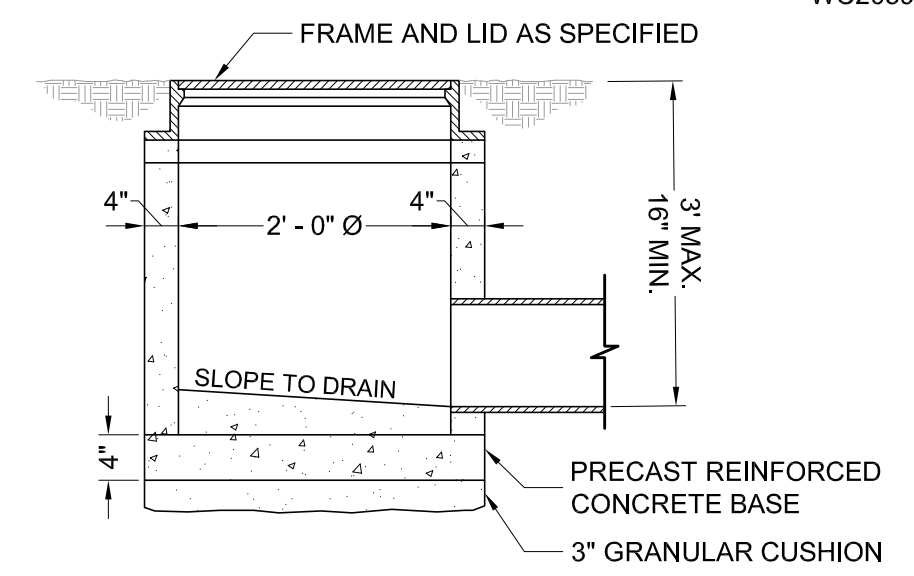

NOTES:

- INLETS SHALL BE OF PRECAST REINFORCED CONCRETE SECTIONS.
- PIPE OPENINGS, AS INDICATED ON THE PLANS, SHALL BE CAST INTO THE WALL SECTIONS.
- ALL INLETS SHALL BE CONSTRUCTED WITH A PRECAST REINFORCED CONCRETE BASE.
- ALL JOINTS BETWEEN PRECAST RISER, TOP SLAB SECTIONS, ADJUSTMENT RINGS AND CASTINGS SHALL BE SEALED WITH A BITUMASTIC MATERIAL.
- MORTAR SHALL NOT BE USED TO DRESS UP ADJUSTING RINGS.
- STEPS SHALL BE IMBEDDED INTO THE WALL A MINIMUM OF 4" AND SHALL NOT BE EXTENDED ON THE OUTSIDE.
- FRAME AND LID CASTING SHALL BE AS SPECIFIED ON THE PLANS.
- THE CONTRACT UNIT PRICE FOR INLETS SHALL INCLUDE THE FRAME AND LID, STEPS AND THE GRANULAR CUSHION.
- WHERE A FLAT TOP IS REQUIRED, IT SHALL BE PRECAST AND CONFORM TO IDOT STANDARDS.

3 FRAME AND LIDS TYPE 1
SCALE: NTS

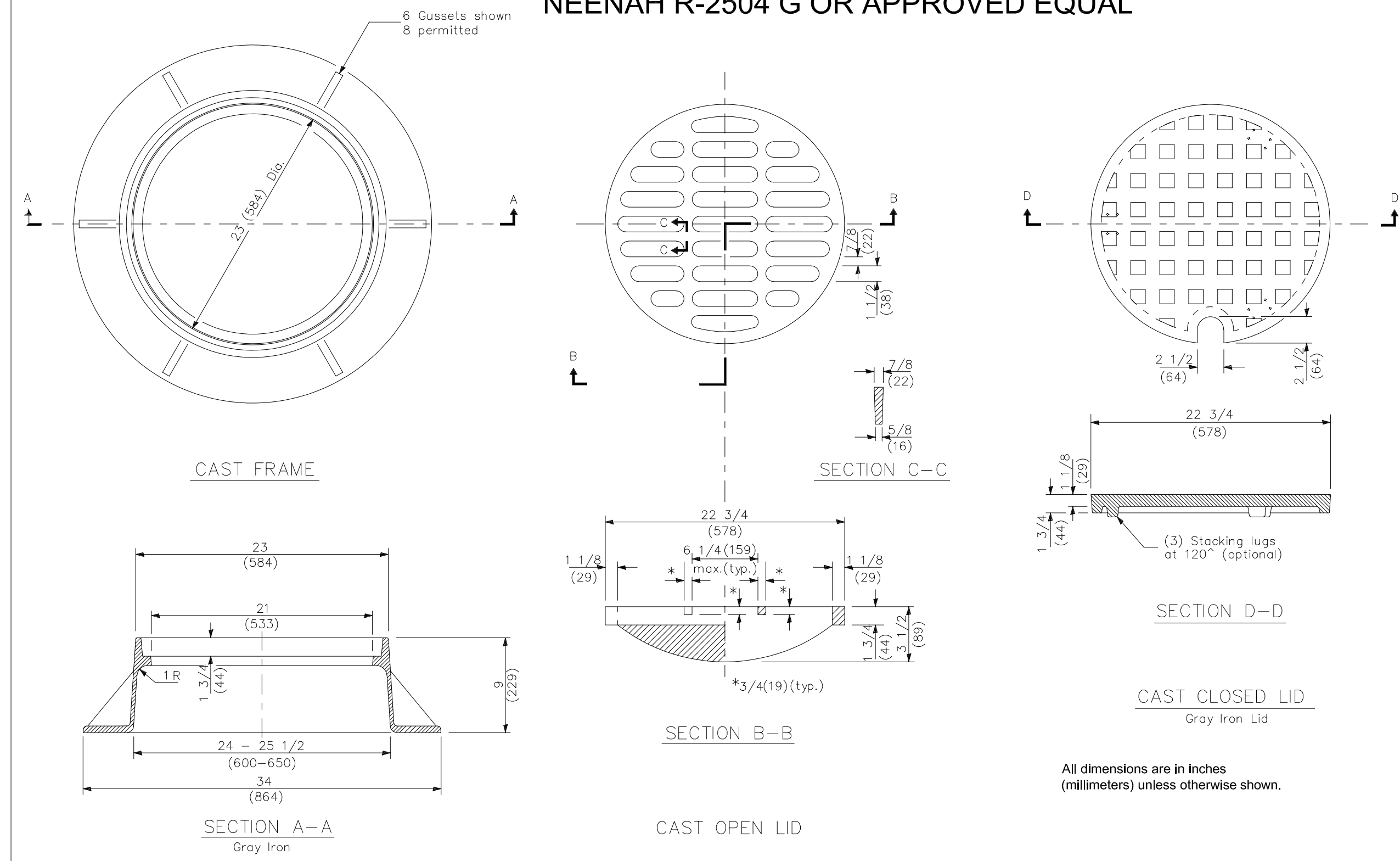

NEENAH R-2504 G OR APPROVED EQUAL

All dimensions are in inches (millimeters) unless otherwise shown.

S:\Darien\Downers Grove SD99\220242_North Capital 2023\01\11 Drawings\02 CD\220242 C4.00 CIVIL DETAILS.dwg devans Feb 10, 2023 9:52:04 am Wight © Copyright All rights reserved. No part of these documents may be reproduced, stored, or transmitted in any form or by any means, electronic, mechanical, photocopying, recording or otherwise, without the prior written consent of Wight.



Wight

Wight & Company
wightco.com
2500 North Frontage Road
Darien, IL 60561
P 630.969.7000
F 630.969.7979

ADDENDUM 1	02/10/2023	
IFB	01/23/2023	
CLIENT PAGE TURN	12/14/2022	
REV	DESCRIPTION	DATE

**DOWNERS GROVE
NORTH - SUMMER
2023 CAPITAL
IMPROVEMENTS**
4436 MAIN STREET
DOWNERS GROVE, IL 60515

CIVIL DETAILS

Project Number:
220242
Drawn By:
DE
Sheet:

C4.01